

2" MAXLINE Installation Procedures

INSTALLATION This system uses a crimp style fitting

TOOLS REQUIRED To install the fittings, you will need the following:

- M8551 WHEELED TUBING CUTTER
- M8595 BEVELING TOOL
- M8590 HYDRAULIC CRIMP TOOL

PROCEDURE

- 1) CUT the tubing square, with wheel type cutter, apply extra pressure so wheel does not walk out of cut groove.
- 2) APPLY soapy water to the ALUMINUM plunger use a soft hammer to pound the plunger into the tubing and back out again (this makes the tubing round after cutting)
- 3) BEVEL the inside of the tubing with the reaming tool. Rotate repeatedly until a large chamfer forms.
- 4) APPLY soapy water to the fitting and tubing end. Put crimp sleeve on the tubing, and push fitting stem into the tubing fully
- 5) CRIMP fitting 3 times with hydraulic tool, each 120 degrees apart. 60 MPA on the gauge
- 5) COMPLETED CRIMP

BENDING

Use a gradual sweeping radius for corners
(36"-48" Bend Radius)

BURIAL

This product can be direct buried in the soil or directly under concrete, please wrap any fitting underground with shrink tubing.

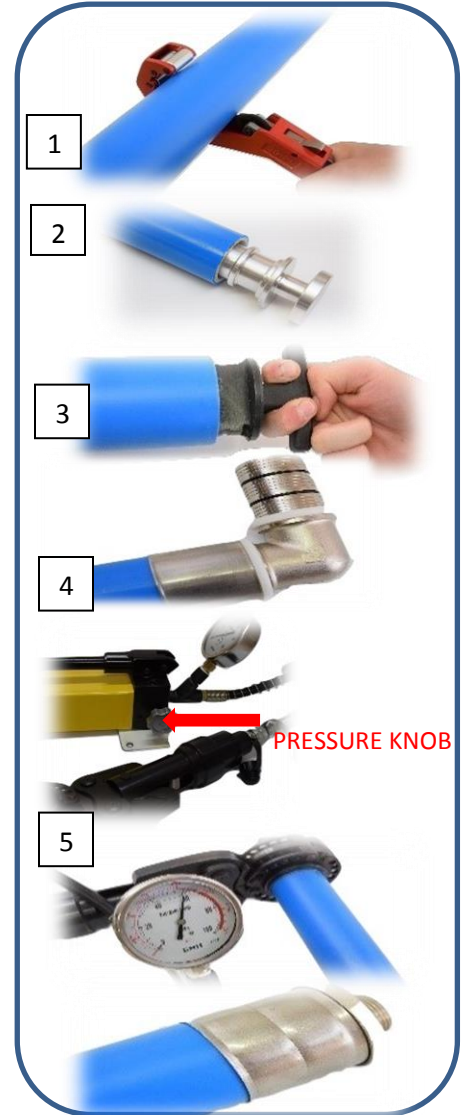

WARNINGS

- **MAXIMUM WORKING PRESSURE FOR THIS SYSTEM IS 200 PSI**
- **COMPRESSED AIR IS DANGEROUS IF NOT USED PROPERLY**
- **DO NOT POINT COMPRESSED AIR SOURCE AT ANY PART OF YOUR BODY OR AT ANY PERSON**
- **ALWAYS USE EYE PROTECTION WHEN USING COMPRESSED AIR**
- **TURN OFF COMPRESSOR WHEN NOT IN USE**
- **CHECK LOCAL BUILDING CODES BEFOR INSTALLATION**
- **CA PROP 65:** This product contains chemicals, including lead, known to the state of California to cause cancer and birth defects or other reproductive harm
- **CONTAINS LEAD:** MAY BE HARMFUL IF EATEN OR CHEWED. MAY GENERATE DUST CONTAINING LEAD
KEEP OUT OF REACH OF CHILDREN.

Engineered Specialties, LLC 800-954-3310

For tips and warranty information, visit www.rapidairproducts.com REV1 10-2016